

LXIPB4-VF

4MP WDR Motorized Vari-focal Bullet Network Camera



Features

- 4.1MP, 2688x1520@20fps
- 2.8-12mm motorized lens
- True WDR 120dB
- IR up to 100ft
- Support on-board storage up to 128GB
- IP67 water-proof
- DC 12V, POE
- Support H.264+

Dimensions

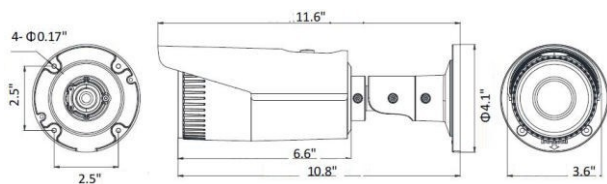

Order Model

LXIPB4VF

Optional Brackets



Camera	
Image Sensor	1/3" progressive scan CMOS
Min. Illumination	Color: 0.01Lux @(F1.2,AGC ON) ,0 Lux with IR, B/W: 0.0073Lux @(F1.4, AGC ON), 0 Lux with IR
Shutter Speed	1/3 s to 1/100,000 s, support slow shutter
Lens	2.8 mm to 12 mm @ F1.4 , horizontal field of view: 108 to 31
Image	
Lens Mount	Φ 14
Day &Night	IR cut filter with auto switch
3-Axis Adjustment	Pan: 0 to 355 ; Tilt: 0 to 100 ; Rotation: 0 to 355
DNR	3D DNR
WDR	120 dB
Compression Standard	
Video Compression	Main stream: H.264+/H.264; Sub stream: H.264/MJPEG
H.264 Type	Main Profile/High Profile
Video Bit Rate	32 Kbps to 16 Mbps
Image	
Max. Resolution	2688 x 1520
Main Stream Max. Frame Rate	50Hz: 20fps @(2688 x 1520), 20fps @(2304 x 1296), 25fps @(1920 x 1080, 1280 x 720) 60Hz: 20fps @(2688 x 1520), 20fps @(2304 x 1296), 30fps @(1920 x 1080, 1280 x 720)
Sub-stream	50Hz: 25fps @(640 x 360, 352 x 288) 60Hz: 30fps @(640 x 360, 352 x 240)
Image Settings	Brightness, saturation, contrast, sharpness are adjustable via web browser or client software
Day/Night Switch	Support auto, scheduled
Others	Mirror, BLC (area configurable), region of interest (support 1 fixed region)
Network	
Network Storage	Support micro SD/SDHC/SDXC card (128G), local storage and NAS (NFS,SMB/CIFS), ANR
Detections	Motion detection
Alarms	Video tampering, network disconnected, IP address conflicted, HDD full, HDD error
Protocols	TCP/IP, ICMP, HTTP, HTTPS, FTP, DHCP, DNS, DDNS, RTP, RTSP, RTCP, NTP, UPnP, SMTP, SNMP, IGMP, 802.1X, QoS, IPv6, Bonjour
Standard	ONVIF (PROFILE S, PROFILE G), PSIA, CGI, ISAPI
General Function	One-key rest, anti-flicker, heartbeat, mirror, password protection, privacy mask, watermark, IP address filter
Interface	
Communication Interface	1 RJ45 10M/100M self-adaptive Ethernet port
Video Output	1Vp-p Composite Output (75Ω/BNC)
Reset	Support
General	
Operating Conditions	-22 F to 140 F, Humidity 95% or less
Power Supply	DC12V 25%, PoE (802.3af)
Power Consumption	Max. 5.5 W/11 W
Ingress Protection	IP67
IR Range	66ft-100ft
Dimensions	3.6" x 4.1" x 11.6"
Weight	2.6 lb

* Product specifications may change without prior notice.

